



New Government Quarter underway

The Government Quarter is being restored in the suburb of Hammersborg. According to the plan, there will be five new buildings built, divided into three stages of construction. Two buildings will be rehabilitated, while three of the buildings damaged after the terrorist bombing in 2011 have been demolished.

Over a long period, important work and processes for a democratic society have been investigated, planned, drawn, discussed and decided in the development of a Government Quarter for the whole country. But construction is now underway. It was started in January 2021 and a new quarter will take shape into the 20s.

With the exception of the Ministry of Defence, all ministries will be located in the new quarter. A gathering of the ministries has been important with regard to security, use of resources and streamlining. The objective is for the new Government Quarter to become an attractive, well-functioning and safe workplace that enables a good and efficient community of ministries. With the concept of an activity-based workplace, employees will be able to work where appropriate based on the relevant task. This will ensure the ministries great flexibility and access good possibilities for interaction.

Through its location, character of the urban spaces and the architecture of the buildings, the new Government Quarter will become a new district representing the authorities of the country. The district will have a monumental character without appearing flashy or derisive and it will be open, safe, green and accessible at all times - early and late and in all seasons - by everyone who uses the city. The developer of the new Government Quarter is Statsbygg as part of a team that includes some of the foremost architects, advisors and contractors in the country.

Milestones

- 2025 - 2030 ● Expected move to the new Government Quarter.
- 2021 - 2030 ● Expected implementation of Construction stages 1, 2 and 3.
- 2021 ● The formal start of the construction of the new Government Quarter will begin with the rehabilitation of the High rise building and construction of the basement and D-Block.
- 2020 ● The feasibility project for construction stage 1 has been completed and external quality assurance (KS2) carried out. The Storting is giving a green light to the construction of a new Government Quarter with a cost framework of NOK 20.5 billion for construction stage 1.
- 2017 - 2020 ● Work on the design project and feasibility project is further development and specification of the winning proposal in the competition, which was submitted by Adapt.
- 2017 - 2018 ● The temporary national memorial site after the events of 22 July will be established in front of the Lindealléen high rise on Johan Nygaardsvolds plass.
- 2016 - 2017 ● The planning and design competition has been conducted and was won by Team Urbis with the Adapt proposal.
- 2015 - 2019 ● Groundworks, adaptation and structural envelope for technical infrastructure underground on the S-site is completed.
- 2014 - 2021 ● Three buildings will be demolished: S-Block, R4 and Y-Block.
- 2014 - 2017 ● Work on and determination of the zoning plan and space and function programme.
- 2014 ● The Government is approving the main concept for the future Government Quarter. The decision states the overall frameworks and objectives, determines which buildings are to be demolished and which will be preserved and confirms that the Government Quarter will continue to be located in the suburb of Hammersborg in Oslo.
- 2011 - 2014 ● Studies, including concept selection assessment (CSA) and external quality assurance (QA1)
- 2011 - 2012 ● A terrorist bomb hits the Government Quarter. Work on the securing, clean up and sanitisation of the four badly damaged buildings, as well as rehabilitation of the less damaged buildings is being carried out. The ministries affected are provided with temporary facilities.

Construction stages

According to the plan, the new Government Quarter should be completed in 2030. The building project is divided into three stages of construction:

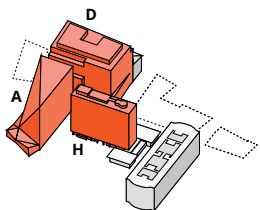

Construction stage 1: Construction of the A- and D-blocks, basement, Ring 1 and perimeter security, as well as rehabilitation of the High rise building

Construction stage 2: Construction of C-Block

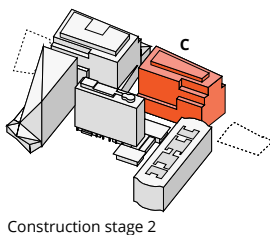

Construction stage 3: Construction of B- and E-Blocks and the rehabilitation of G-Block

Construction stage 1 (2021-2025) is the biggest and covers a total of 101,000 square metres of new buildings and rehabilitation. Lowering and rebuilding the Ring 1 tunnel is part of construction stage 1 but is a separate project with its own cost framework that falls under the Norwegian Public Roads Administration.

Construction stage 1 has been approved by the Storting. Construction stages 2 and 3 have not been detailed and require consideration and approval of the Storting prior to the start of construction.

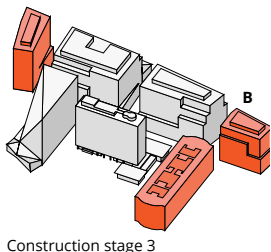

E-block
New building | Construction stage 3
11700 m² | 12 floors
Is to house:
which ministries has not yet been
determined

D-block
New building | Construction stage 1
29.500 m² | 10 floors
Is to house:
Office of the Prime Minister
Ministry of Foreign Affairs

C-block
New building | Construction stage 3
21.600 m² | 11 floors
Is to house:
which ministries has not yet been
determined

B-block
New building | Construction stage 3
7700 m² | 9 floors
Is to house:
which ministries has not yet been
determined

A-block
New building | Construction stage 1
17.300 m² | 11 floors
Is to house:
Ministry of Trade, Industry and
Fisheries
Ministry of Climate and
Environment

High rise building
Rehabilitated in
Construction stage 1
12.800 m² | 15 floors
Is to house:
Ministry of Justice and
Public Security

G-block
From 1906 | Rehabilitated in
Construction stage 3
12.000 m² | 5 floors
Is to house:
Ministry of Finance





The Idea

The new Government Quarter is to be permanent, stately, attractive and friendly.

Permanent: functional and lasting for generations

Stately: a physical manifestation of the Norwegian democracy

Attractive: creates delight and pride

Friendly: invites a visit and activity

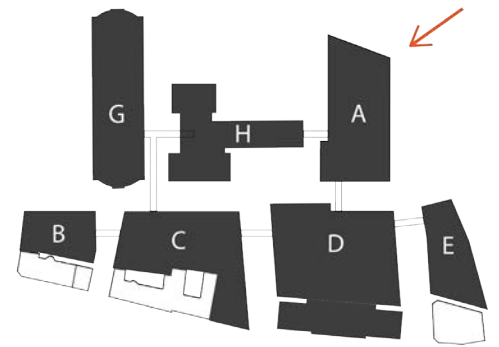

Facades, front and backdrop

While A-Block, the High rise building and G-Block the buildings fronting onto Akersgata, the B-, C-, D- and E-Blocks and the buildings on Grubbegata form a backdrop of buildings in the quarter. It is assumed that a double glass façade in A-Block will be set in a framework of light concrete.

A-Block is shaped in order to provide lines of sight into the park, good sun and wind conditions, as well as a distinctive profile. One of the two main entrances to the Government Quarter is located in A-Block, connected to an appealing, raised atrium.

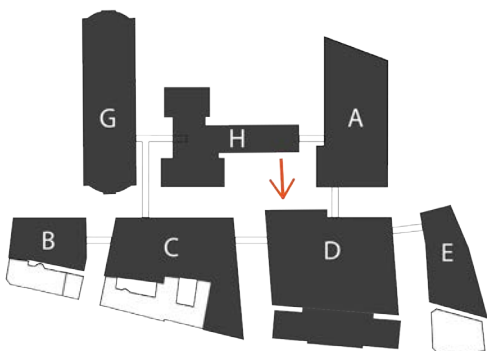

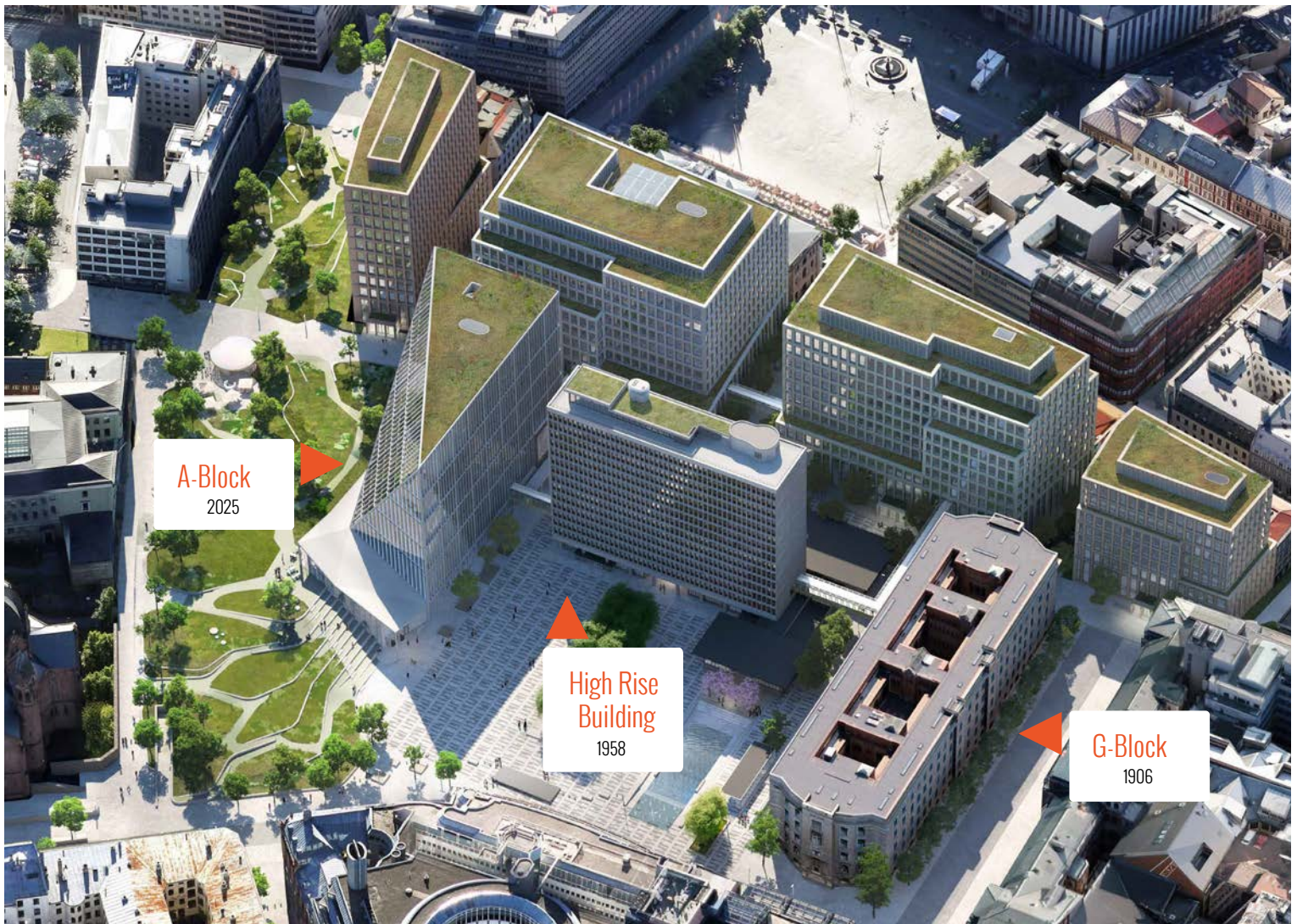

Historic front buildings

Both G-Block (1906) and the High rise building (1958) are period buildings with clear features that will continue to be part of the future Government Quarter. Along with the new A-Block (2025), there will be three distinct buildings fronting onto Akersgata.



These front buildings represent a historical continuity:

- G-Block:** a fresh Norway following dissolution of the union
- High rise building:** post-war reconstruction
- A-Block:** the modern Norway

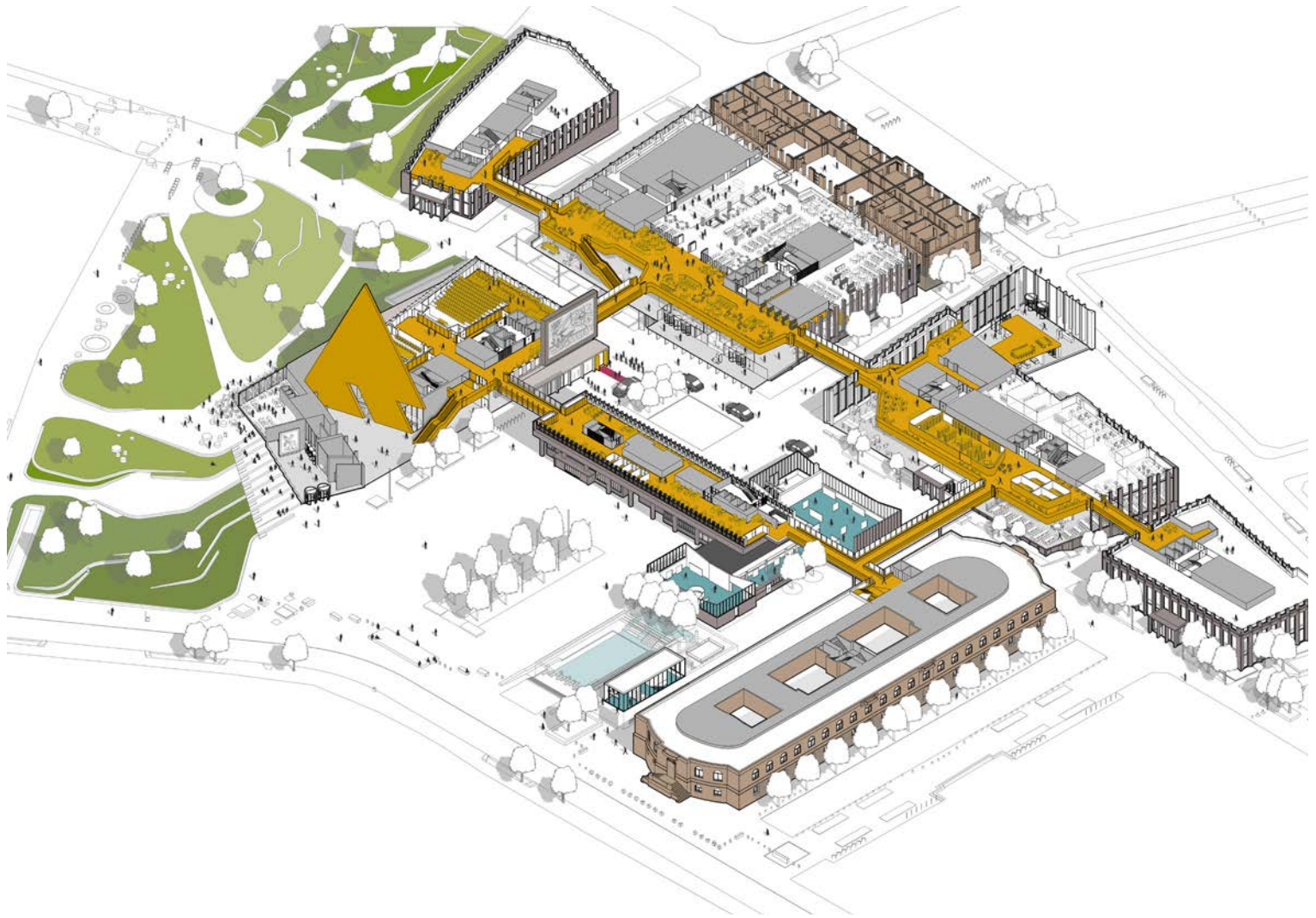

Interactive area

In order for the ministries to be able to function efficiently and in the best interests of the nation, interaction must be facilitated both within each ministry and between the ministries.

The interactive area will be established on the 2nd floor in the Government Quarter. This will connect all the buildings via bridges and provide access to communal facilities, stairs and lifts to the offices on the floors above and entrances and exits.

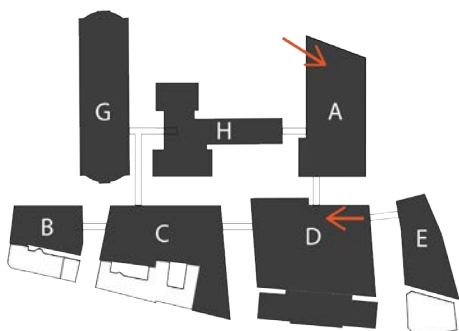

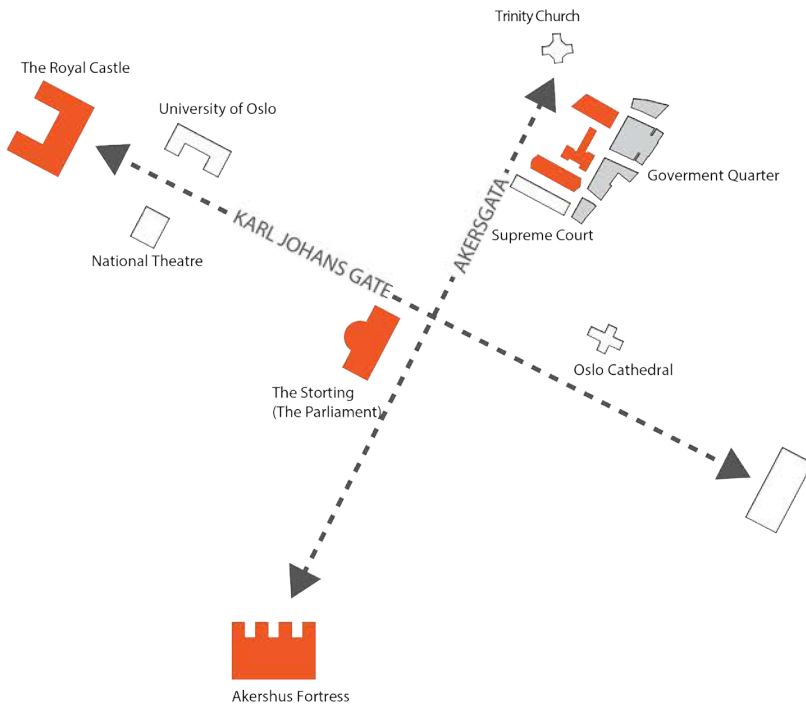

Located along the urban axis of Akersgata

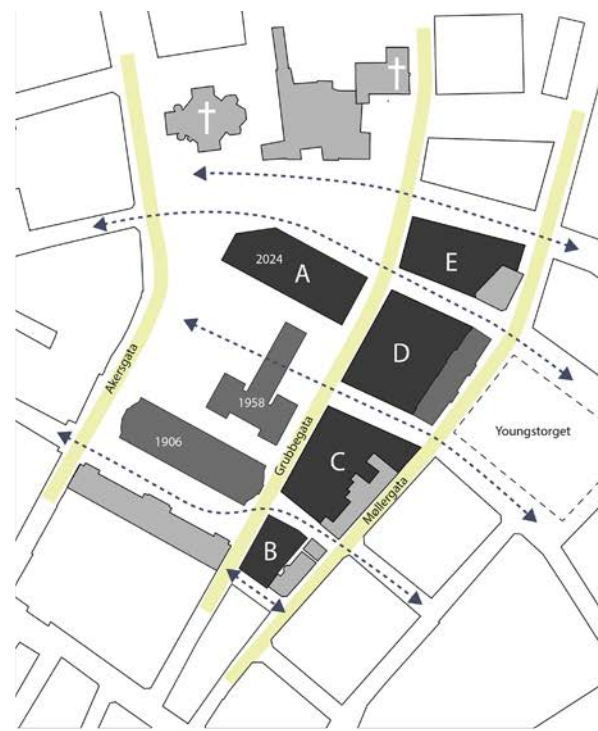

Open urban structure

Project framework

- The new Government Quarter will be located between Møllergata and Akersgata
- The buildings will be of moderate height and in varying sizes and volumes
- The two floors added to the High rise building will be demolished in order to restore the original appearance of the building from 1958
- The High rise building will remain the tallest building in the Quarter
- Main access will be from Akersgata
- An extended security zone will be established around the Quarter
- The Ring 1 tunnel will be lowered and extended
- A new park is being established over Ring 1 in the north-eastern part of the area
- The whole area will be open to pedestrians and cyclists

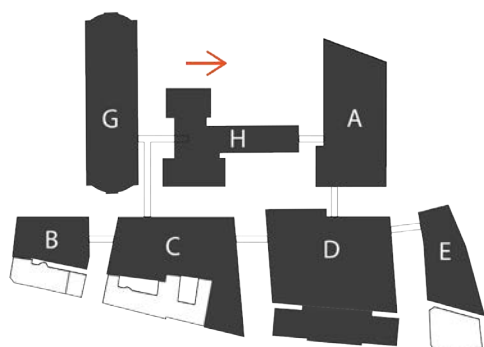

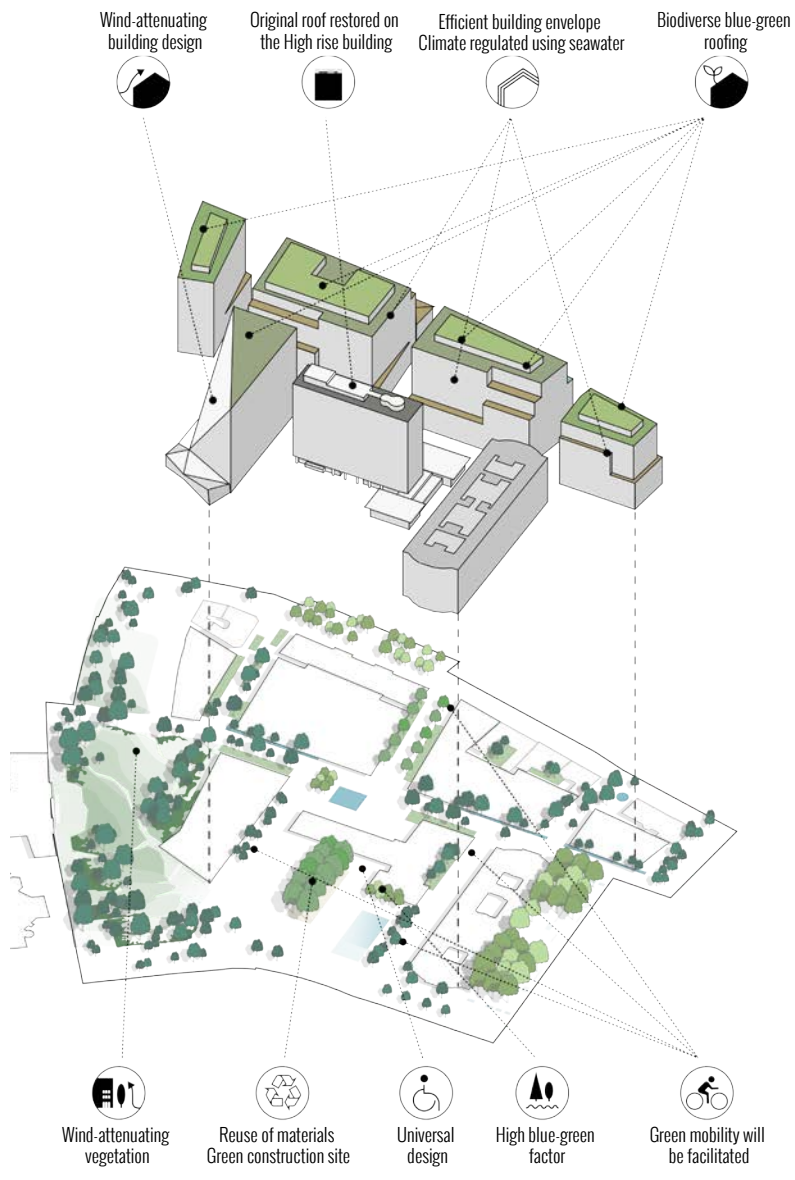

Blue-green measures

The Government Quarter will become a blue-green suburb in which urban nature with both existing and new vegetation, water features, fountains and water arrangements are inviting to visit and for traffic.

Urban nature will contribute to increasing the biodiversity with insect, animal and bird life in the area and to establish a robust and diverse ecology.

The surfaces of the roofs of the buildings cover 7,900 m² and will also become blue-green. They will be covered with different forms of vegetation and will have a local, open rainwater management that acts as a diversion system in the event of precipitation. The roofs are also likely to contribute to increased species diversity in the city.





“The Fishermen” and “The Seagull”

“The Fishermen” and “The Seagull” by Pablo Picasso are two large concrete murals that were sandblasted onto the concrete by Carl Nesjar. On the basis of artistic and architectural assessments, it is planned for the works of art to be found a new home in the new Government Quarter as part of the new A-Block. The Picasso administration has approved this placement.

The works were part of Y-Block, which has now been demolished. They were removed in the summer 2020 and are now in two large wooden boxes in front of the high rise building, which can be seen from Akersgata.

“The Fishermen” measures 14 x 11 metres and weigh over 100 tonnes. With the stabilising steel frame, it weighs 200 tonnes. The work of art and the red steel frame can be seen through the window of the wooden box.

“The Seagull” measures 5 x 6 metres and weighs 20 tonnes with the steel frame. The work of art is standing in a sealed, temperate box as it has been in an indoor climate since it was created in 1969.

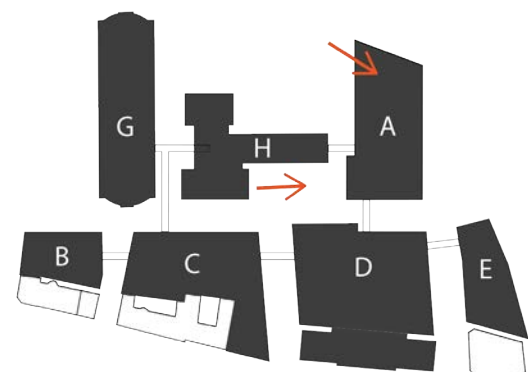



New park and café

The area is currently characterised by an incoherent expansion and development in which little attention has been given to the inhabitants of the city and their patterns of movement. The Government Quarter will now be stitched together with the rest of the city so that it will be much easier to walk and cycle through it and historic buildings will have a new frame. The East-West axes in particular will be clearly improved.

A new park between the Government Quarter and the old Deichmanske main library will bring green enrichment to the suburb. The park will play a central role in the balance between the representative and the daily life of the inhabitants of the city. There will be a café in A-Block open to the public associated with the park. On Møllergata there will be businesses open to the public and there are plans for collaborations regarding urban life with neighbours of the Quarter.



New park with exciting design



Variety with water and lush vegetation edging

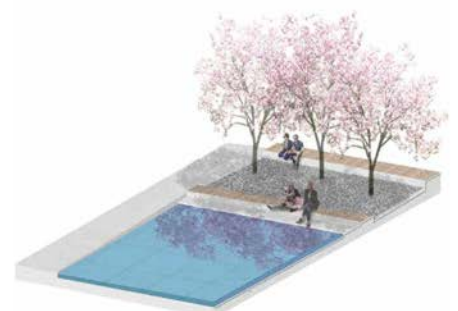
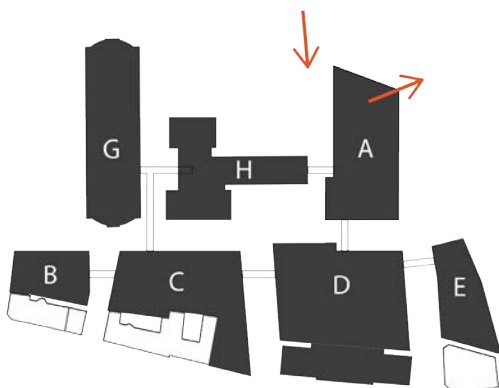

Calming water features and active fountains



